

# C2EFL05VV

ELECTRIC GRIDDLE PLATE SMOOTH + OPEN CABINET - SOLUTION LINE



## PRODUCT DESCRIPTION

Stainless steel frame. Athermic thermoset plastic knobs with useful screen printed edges.

Heating obtained through **tubular heating elements with stainless steel sheath** placed in direct contact with the cooking plate.

Temperature regulation through a thermostat. Working temperatures between 90°C and 300°C. Safety thermostat with manual reset against equipment malfunctioning.

**Single large, thick cooking plate** with smooth finish that allows excellent heat transmission. **Welded splash guard**. The cooking plate is installed on the worktop with a **slight inclination** to allow grease to flow towards the drain.

### Smooth cooking plate.

AISI 304 stainless steel worktop with rounded corners for easy cleaning. Stainless steel front, side and back panels.

Large hole on the cooking surface for draining fats into a large capacity container placed under the cooking surface itself. **Standard equipped** with a grease collection container.

A Teflon plug, suitable to plug the drain in case of any cooking with a film of oil, available **on demand**.

Laser-cut work top finishing for "head-to-head" matching and binding fastening.

**Height-adjustable** stainless steel legs.

Accessories available **on demand**.



## TECHNICAL SPECIFICATIONS

**Width:** 400 mm

**Depth:** 700 mm

**Height:** 850 mm

**Weight:** 49 kg

**Volume:** 0.45 m<sup>3</sup>

**Electrical power:** 4.10 kW



## C2EFL05VV

**FRY TOP ELETTRICO PIASTRA LISCIA IN ACCIAIO DOLCE CON PARASPRUZZI + VANO APERTO**

**PLAQUE A SNACKER ELECTRIQUE LISSE EN ACIER DOUX AVEC PARE-JETS + BAIE LIBRE OUVERTE**

**ELECTRIC GRIDDLE PLATE SMOOTH MADE OF MILD STEEL WITH SPLASH-GUARDS + OPEN CABINET**

**ELEKTROGRIDDLEPLATTE GLATTE BRATFLÄCHE AUS WEICHEM STAHL MIT SPRITZSCHUTZ + UNTERBAU OFFEN**

**FRY TOP ELECTRICO PLANCHA LISA EN ACIERO DULCE CON CHAPA ANTISALPICADURAS + BASE BIERTA**

**ЗЛЕКТРМУЕСКАЯ ШАРОУНАЯ НОВЕРХНОСТЬ, РЛАДКАЯ, МЯРКАЯ СТАЛЬ, С ЗАЩМТНЫММ ЗКРАНАММ ОТ БРЫЗР + ОТКРЫТЫ ШКАФ**

**DATI TECNICI / CARACTERISTIQUES TECHNIQUES / TECHNICAL SPECIFICATIONS / TECHNISCHE DATEN / CARACTERISTICAS TECNICAS / ТЕХНИЧЕСКИЕ ХАРАКТЕРИСТИКИ**

Dimensioni / Dimensions / Dimensions / Maße / Medidas / Размеры	[MM]	800x700x255
Potenza elettrica / Puissance électrique / Electric Power / Elektro-Leistung / электр. (E)	[Kw] - [кВт]	4,1
(F)	[V]	400/3N
(G)	[Hz] - [Гц]	50/60
Cavo (non fornito in dotazione) / Cable (non fourni) / Cable (not supplied) / Kabel (nicht mitgeliefert) / Cable / Кабель	H07 RN-F [MM <sup>2</sup> ]	5 x 1,5
Voltaggi diversi e versioni navali disponibili su richiesta / Différentes tensions et versions maritimes disponibles sur demande / Different voltages and marine versions available on request / Verschiedene Spannungen und Schiffsausführungen auf Anfrage erhältlich / Различные напряжения и варианты исполнения корабля - по запросу		
Piastra liscia in acciaio dolce con paraspruzzi Plaque lisse en acier doux avec pare-jets Smooth plate of mild steel with splash-guards Glatte Bratfläche aus weichem Stahl mit Spritzschutz Plancha lisa en acero dulce con chapa antisalpicaduras Гладкая конфорка Стальная плита с защитными экранами		X

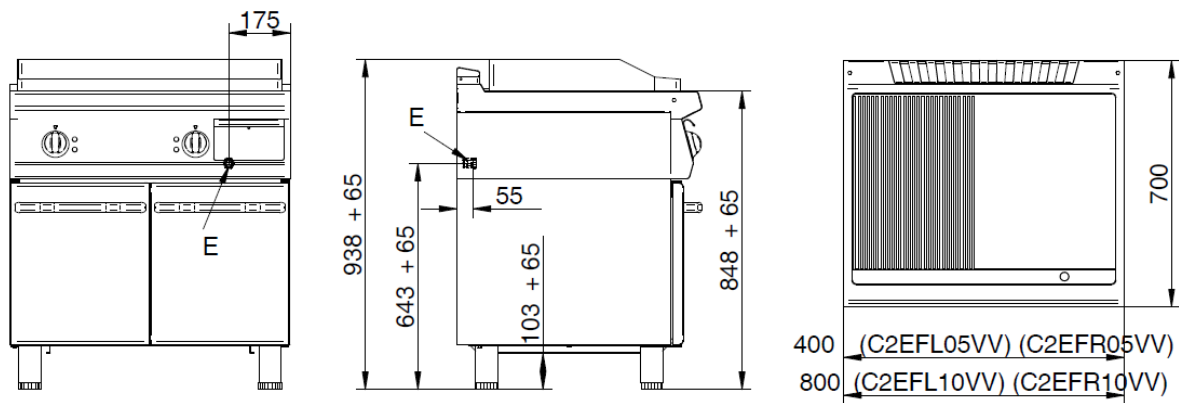

E= elettrico \ électrique \ electric \ Elektrisch \ eléctrico \ электрич

Optional

n.1 x **K7PORTA** Porta - Porte - Door - Tür - Puerta – Дверца