

# K4EGDP05VV

ELECTRIC DIRECT GRILL 1/2 MODULE + OPEN CABINET



## PRODUCT DESCRIPTION

Stainless steel frame. Athermic thermostet plastic knobs with useful screen printed edges.

Heating obtained through **heating elements with AISI 304 sheath**, which work in air and are suitable for the temperatures to which they are exposed (400°C). The heat load of the heating elements allows **heat exchange only towards the food** to improve cooking and energy savings. Safety thermostat with automatic reset to protect the heating elements. Energy regulator adjusting the frequency of ON-OFF operation of the heating elements. The maximum continuous operation position is useful in the cleaning process, as it induces pyrolysis of the fats on the heating elements.

**AISI 304 cold-pressed water tank with drain hole.** The water improves the quality of the food cooked and carries the cooking fats to the drain.

**Tap for filling and refilling water** placed on the frontal panel. **Tank drain** placed on the frontal panel and operated by a lever.

2 mm thick moulded AISI 304 stainless steel worktop with rounded edges for easy cleaning. Stainless steel front, side and back panels.

Laser-cut work top finishing for "head-to-head" matching and binding fastening.

**Height-adjustable** stainless steel legs.

Accessories available **on demand**.



## TECHNICAL SPECIFICATIONS

**Width:** 400 mm  
**Depth:** 900 mm  
**Height:** 850 mm  
**Weight:** 55 kg  
**Volume:** 0.56 m<sup>3</sup>  
**Electrical power:** 5.40 kW



## K4EGDP05VV

GRIGLIA ELETTRICA DIRETTA + VANO APERTO - GRILLE ÉLECTRIQUE DIRECTE + BAIE LIBRE OUVERTE - DIRECT ELECTRIC GRILL + OPEN CABINET - DIREKTER ELEKTROGRILL + OFFENER UNTERSCHRANK PARRILLA ELÉCTRICA DIRÉCTA + BASE ABIERTA - ЭЛЕКТРОУЕСК' Р'ЛЬ ПРЯМОРО НАРРЕВА + ОТКРЫТЫ ШКАФ

**DATI TECNICI / CARACTERISTIQUES TECHNIQUES / TECHNICAL SPECIFICATIONS / TECHNISCHE DATEN / CARACTERISTICAS TECNICAS / ТЕХНИЧЕСКИЕ ХАРАКТЕРИСТИКИ**

Dimensioni / Dimensions / Dimensions / Maße / Medidas / Размеры	[мм]	400x900x850
Potenza elettrica / Puissance électrique / Electric Power / Elektro-Leistung / электр. (E)	[Kw] - [кВт]	5,4
(F)	[V]	400/3N
(G)	[Hz] - [Гц]	50/60
Cavo (non fornito in dotazione) / Cable (non fourni) / Cable (not supplied) / Kabel (nicht mitgeliefert) / Cable / Кабель	H07 RN-F [мм <sup>2</sup> ]	5 x 1,5
Voltaggi diversi e versioni navali disponibili su richiesta / Différentes tensions et versions maritimes disponibles sur demande / Different voltages and marine versions available on request / Verschiedene Spannungen und Schiffsausführungen auf Anfrage erhältlich / Различные напряжения и варианты исполнения корабля - по запросу		
Press. Acqua - Pression eau - Water pressure - Wasserdruck - Presion agua - Давл. воды	[bar] [бар] MAX МАКС	300
Raccordo acqua / Raccordement eau / Water fitting / Wasseranschluss / Empalme agua / Фитинг воды		UNI-ISO 7/1 R ½

### Optional

n. 1 x **K7PORTA** Porta - Porte - Door - Tür - Puerta – Дверца

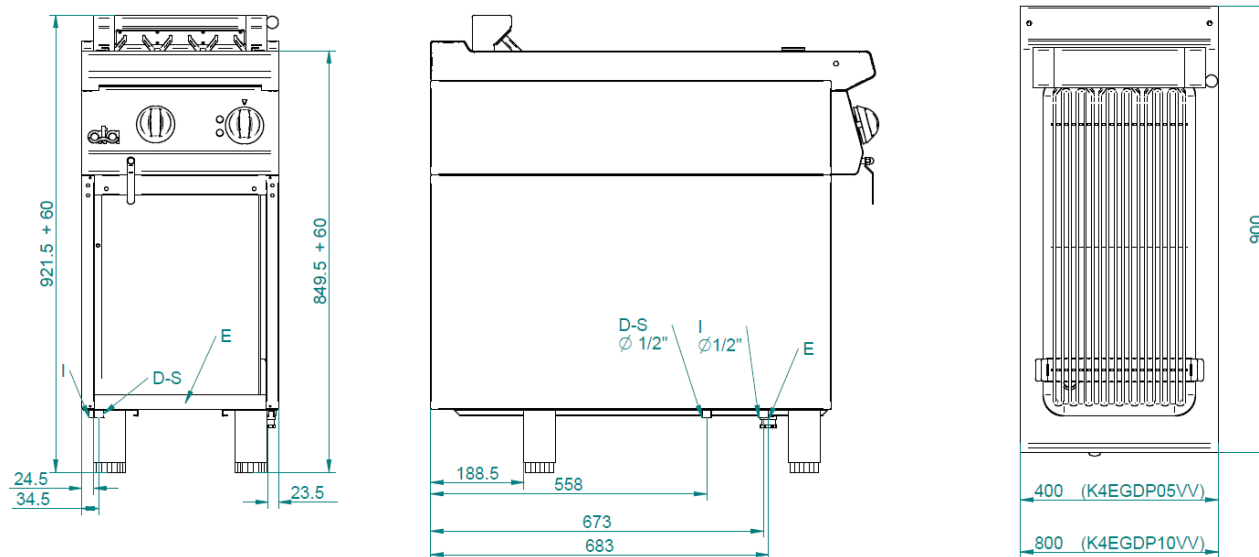

E= elettrico \ électrique \ electric \ Elektrisch \ eléctrico \ электрич

C= Carico acqua \ Remplissage d'eau \ Water filling \ Wasser anfüllen \ Carga agua \ Заливка воды

S-D= Scarico acqua \ Évacuer l'eau \ Water emptying \ Wasser entleeren \ Descarga agua \ Слив воды